

# SARA

CLIENT SLEEPS WELL

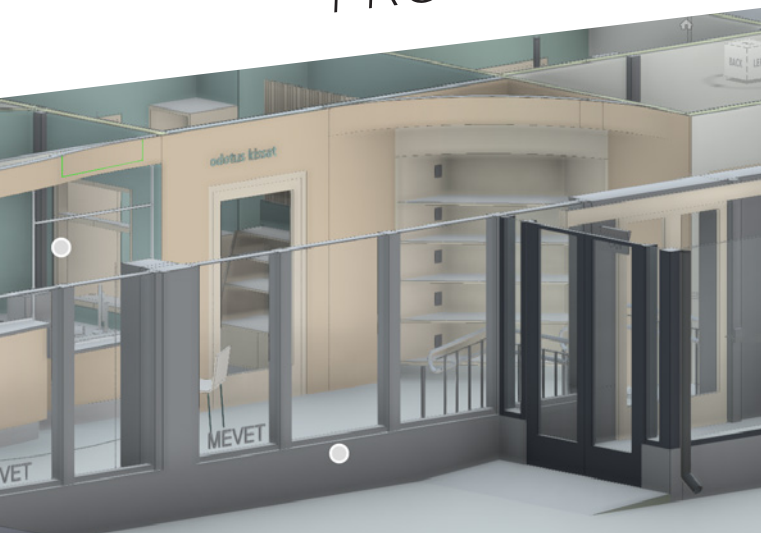

CASE: **EVIDENSIA MEVET** - VETERINARY HOSPITAL  
PROJECT MANAGEMENT BENCHMARK





**TIMO KAMPURI**

CEO - SARA

WATCH OUR  
VIDEO:



"Europe's finest Veterinary Hospital in a tight schedule" The Evidensia Mevet project demonstrated what can be achieved with careful initial development, right tools, professional project management and thorough cooperation.

During the project, all stakeholders had access to a shared platform that enabled active observation and commenting of up-to-date models and plans. In addition, weekly planning meetings ensured smooth and continuous progression.

This case was a perfect example of a well supervised and managed project. Co-operation was seamless between all project members and sharing of information was impeccable from start to finish.

Carefully designed and now proven process is suitable for different kinds of projects  
- not only for veterinary hospitals.

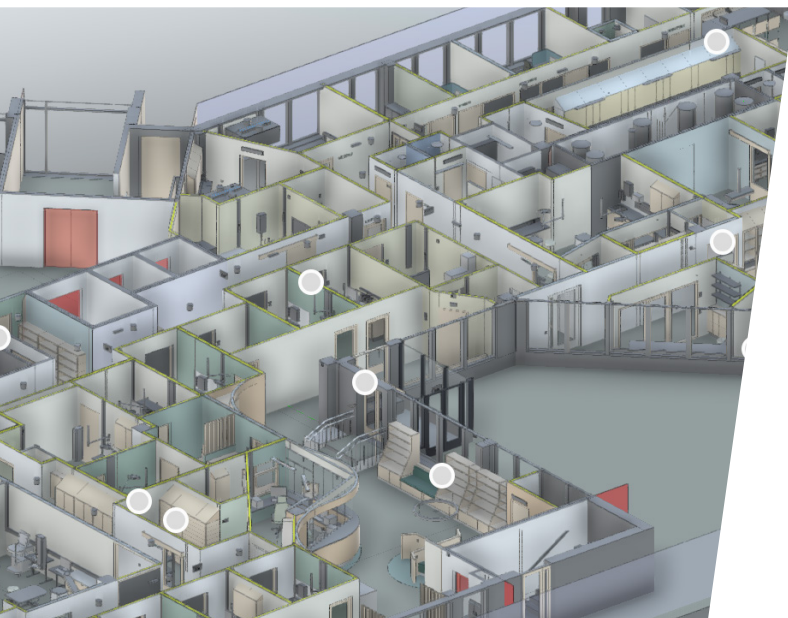

SÄHKÖ  
✉ [juhani.eerila@ayravainen.fi](mailto:juhani.eerila@ayravainen.fi)  
☎ 040 726 6675

LVIA  
✉ [toni.salonen@ayravainen.fi](mailto:toni.salonen@ayravainen.fi)  
☎ 040 515 6444

LUOTETTAVAA TALOTEKNIKKASUUNNITTELUA  
TOIMITILARAKENTAMISESTA SAIRAALAYMPÄRISTÖIHIN

**ÄYRÄVÄINEN**

TAMPERE

[www.ayravaintampere.fi](http://www.ayravaintampere.fi)

One focus point in this project was user orientation. With the help of received client and end user feedback, the versatile needs were considered and brought through designs to the site, thus ensuring an excellent outcome.

SARA's project engineer Konsta Ylinen did a master's thesis from this project. The thesis dealt with managing a user-oriented business premises construction project.

Konsta interviewed stakeholders to get a better understanding of the user centric process as well as broader picture of different needs of the parties involved. The customer feedback was extremely valuable for successful execution.

As a result, Evidensia is happy with the project and will start conceiving the outcome for further purposes.



Timo Kamppuri - CEO, SARA  
Pauliina Kotamäki - Clinic manager, Evidensia



**Atlas Copco - your partner  
for reliable and self-sufficient  
oxygen production**



**Happigeneraattorit - Atlas Copco Finland**



# SARA

## Contact information

Suomen Aluerakennuttaja Oy – SARA  
Tulli Business Park, Åkerlundinkatu 11  
33100 Tampere

SARA offers the complete range of construction project management services. Having engineers and architects in the same office provides a tremendous advantage in terms of synergy.

Please find more information:



Eläinsairaala Mevet  
Hiomotie 4  
00380 Helsinki  
<https://evidensia.fi/>



## IMAQEN

Olemme terveysteknologian laitteistojen **luotettava** ja **osaava** toimittaja. Huolehdimme laitteistojen toimivuudesta niiden koko elinkaaren ajan, jotta te voitte keskittyä hoitamaan potilaitanne.

[imaqen.fi](http://imaqen.fi)

- Röntgenlaitteet
- Detektorit
- Kannettavat röntgenlaitteet
- Kuvalevylukijat
- Ultraäänilaitteet
- Röntgentarvikkeet
- Röntgenlaitteiden laadunvarmistus palveluna
- Huoltosopimukset



Röntgentekno Oy, Imaqen | Käynti Kirkkokatu 1a ajoportin kautta | ☎ 044 721 0530 | ✉ [orders@imaqen.com](mailto:orders@imaqen.com)



## BASIN HERÄÄMÖHÄKIT

Laadukkaat heräämöhäkit kokonaistoimituksella  
*Mitoitus, luonnoskuvat ja tarkistus.*

- Hygieeninen muovirunko
- Ovimallit RST kalteri tai RST / Polycarbonaatti
- RST säätöjalat tai liikuteltava malli lukittavilla pyörillä
- Sähkö / Kaasukourun kiinnityspaikat tarvittaessa

**Valmistus, asennus ja kuljetus!**

Lisätietoja ja kuvia  
heräämöhäkeistä:

[www.basin.fi](http://www.basin.fi)

**Basin**  
MUOVIHITSAUS

Muovihitsausta  
jo yli 15 vuoden  
kokemuksella

Ota yhteyttä!

✉ [basin@basin.fi](mailto:basin@basin.fi)  
☎ +358 400 785446